

Technical requirement

1. Design & manufacture conform to BS 1873
2. Face to face dimension to ASME B16.10
3. Flange Dimension to ASME B16.5
4. Pressure-temperature base ASME B16.34
5. Testing and checking API 598

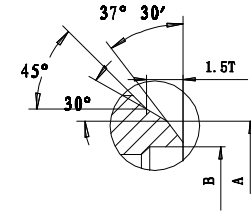

6"	610	168.3	124.5
NPS	L	A	B

MAIN DIMENSIONS (UNIT:MM)

11	Nut	ASTM A193 B16			
10	Packing	Flexible Graphite	21		
9	Pin	ASTM A276 410	20	Gear	Assemble Part
8	Yoke	ASTM A216 WCB	19	Nut	ASTM A194 2H
7	Gasket	ASTM A276 410	18	Bolt	ASTM A193 B7
6	Gasket	304+Graphite	17	Splint	ANSI A1045
5	Valve Core	ASTM A182 F6	16	Nut	ASTM A194 4
4	Stem	ASTM A182 F6+ENP	15	Gasket	ASTM A276 410
3	Small Disc	ASTM A182 F6+STL	14	Gland Flange	ASTM A216 WCB
2	Big Disc	ASTM A182 F6+STL	13	Gland	ASTM A276 410
1	Body	ASTM A216 WCB	12	Eyebolt	ASTM A193 B16
NO.	PART NAME	MATERIAL	NO.	PART NAME	MATERIAL

PERFORMANCE SPECIFICATION					
TEST PRESSURE	CLASS	2500LB		GLOBE VALVE TYPE: J561Y-2500LB-00 NPS 6" DESIGN CHECK DRAWING No. APPROVAL	
	SHEEL TEST	63.0	MPA		
	BACK SEALTEST	46.2			
	SEAL TEST	46.2			
	AIR TEST	0.6			
SUTIABLE TEMPERATURE			425°C		